

# **Year 4 Residential**

**26th February - 28th February 2025**

**Robinwood**

**Dobroyd Castle**

**Todmorden**



All about

Robinwood



- Three centers around the country.
- They provide 24/7 care to our school whilst we are there.
- The 3 day, 2 night residential course packs in 15 exciting activities providing the right balance by offering activities that will challenge, develop teamwork and stimulate the imagination.
- Each activity group has a Robinwood group leader, as well as a Cookridge staff member, who looks after the children throughout their 3 day course, running activity sessions and ensuring everyone achieves great things, whilst at the same time having fun.
- Everything at Robinwood is designed to make a really positive difference in the development of each child that attends.
- Each day and activity is adaptable to the needs, feelings and achievements of the group.

Why do we go back every year?

Quotes from staff and pupils.

Children learn and work together in a different environment.

I conquered my fears.

I made new friends!

I've learnt I can achieve anything if I try new things and push myself.

I don't want to go home!

Some children who are quieter in the classroom succeeded well beyond what had been expected.

# What will Cookridge's residential look like?

## Typical 3 day programme

Around 24 hours of high quality activity sessions packed into a 3 day course. Please note that this activity programme does vary dependent in particular on weather conditions and the timetable given above is only a sample. The activity programme you follow will be confirmed in advance of your course, within a personalised timetable for your school.

### Day 1

- Arrivals are typically about 11.00am
- Lunch
- Giant swing
- Raft building
- Crate challenge
- Evening meal
- Trapeze
- Quest
- Hot chocolate and review

### Day 2

- Breakfast
- Zip wire
- Canoeing
- Archery
- Lunch
- Night line
- Piranha Pool
- Caving
- Evening meal
- Team challenge
- Hot chocolate and review

### Day 3

- Breakfast
- Dungeon of Doom
- Climbing
- Obstacle course
- Lunch
- Departures are typically about 2.30pm

Activities split across three days.

Arrive back at school for roughly 3:45pm on Friday.

High energy, non-stop. An hour after arriving, we are doing activities.

**FUN**

Every day ends with a team challenge, hot chocolate and a review of the day.

**FUN**

# Accommodation

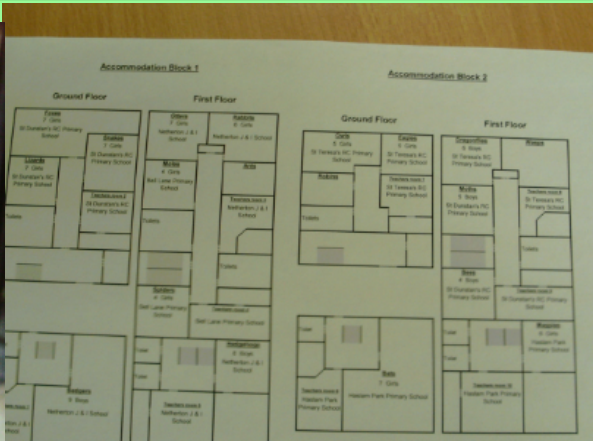
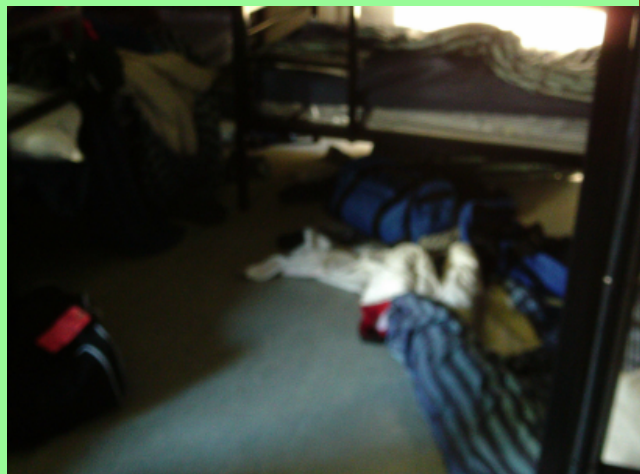

There is plenty of accommodation on offer!

There are three blocks that are used for pupils and teachers as well as the castle and a new, fully refurbished 'cottage' on offer.

Rooms can sleep up to 12 children in bunk beds and each room has a sink. If a child needs the toilet during the night, they can leave their room and use the toilets located on their floor. Showers are located in the 'changing area' and all children have the opportunity to shower daily. Although we cannot force children to shower, they will be actively encouraged to after a long day of activities!

# Meals

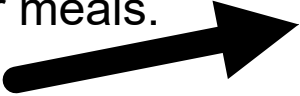
On arrival, every pupil chooses their meals. 

## Breakfast

A choice of toast, cereals, fruit, yoghurt and a cooked breakfast. Pupils can 'build their own' and mix and match!

## Lunch

There is always a hot or cold option, as well as fruit, crisps and a biscuit.

## Tea

A two course meal that fills everyone up after a day of

Meal Selection

Robinwood Meal Choice Form School Winterton Junior School Course Dates 23rd to 25th September 2015  
Iceberg Group Green School Group Lead Jaclyn Love Course Lead Jaclyn Love

| Children           | Evening Meal Day 1    |              |          | Lunch Day 2                 |                        |                 |                 |                    |                  | Evening Meal Day 2 |                     |                 | Lunch Day 3 |                 |                    |                 |                 |                    |
|--------------------|-----------------------|--------------|----------|-----------------------------|------------------------|-----------------|-----------------|--------------------|------------------|--------------------|---------------------|-----------------|-------------|-----------------|--------------------|-----------------|-----------------|--------------------|
|                    | Cheese & Tomato Pizza | Fish Fingers | Choc Ice | 1. Spaghetti Hoops on Toast | 2. Veg Ravoli on Toast | 3. Ham Sandwich | 4. Jam Sandwich | 5. Cheese Sandwich | 6. Tuna Sandwich | 1. Chicken Pasta   | 2. Vegetarian Pasta | 3. Baked Potato | Fruit Jelly | 1. Chicken Wrap | 2. Vegetarian Wrap | 3. Ham Sandwich | 4. Jam Sandwich | 5. Cheese Sandwich |
| Abigail Styles (r) |                       | X            |          |                             |                        | X               |                 | X                  |                  | X                  |                     |                 | X           |                 | X                  |                 |                 | X                  |
| Bailey Chappell    |                       |              |          |                             |                        |                 |                 |                    |                  |                    |                     |                 |             |                 |                    |                 |                 |                    |
| Cody Bishop        |                       |              |          |                             |                        |                 |                 |                    |                  |                    |                     |                 |             |                 |                    |                 |                 |                    |
| Imogen Venable     |                       |              |          |                             |                        |                 |                 |                    |                  |                    |                     |                 |             |                 |                    |                 |                 |                    |
| Jack Lawrence      |                       |              |          |                             |                        |                 |                 |                    |                  |                    |                     |                 |             |                 |                    |                 |                 |                    |
| James Law          |                       |              |          |                             |                        |                 |                 |                    |                  |                    |                     |                 |             |                 |                    |                 |                 |                    |
| Joelliot Smith     |                       |              |          |                             |                        |                 |                 |                    |                  |                    |                     |                 |             |                 |                    |                 |                 |                    |
| Lewis Spindley     |                       |              |          |                             |                        |                 |                 |                    |                  |                    |                     |                 |             |                 |                    |                 |                 |                    |
| Nathan Morrison    |                       |              |          |                             |                        |                 |                 |                    |                  |                    |                     |                 |             |                 |                    |                 |                 |                    |
| Thomas Smith       |                       |              |          |                             |                        |                 |                 |                    |                  |                    |                     |                 |             |                 |                    |                 |                 |                    |
| Toby Wood          |                       |              |          |                             |                        |                 |                 |                    |                  |                    |                     |                 |             |                 |                    |                 |                 |                    |



Allergies, vegetarians, fussy eaters? No problem!

Robinwood caters for everyone. It's a nut free center and all medical information is collated to ensure there's no risk of allergies. There's always two vegetarian options to choose from and any specific dietary needs are catered for as well.

# Clothing

Every child receives a helmet for the required activities.



Kit bags contain waterproof overalls, a woolly hat and a pair of gloves. Children can also place their own clothing in them.



There are magical red wash bins. During the day, dirty clothes go in. The next morning, they are washed and dried.



There is a lost property on site. Inevitably, some items of clothing do occasionally get lost. However, if they are named, most are returned before we leave.

All pupils will receive a kit list around a month before we go.

After years of going, my advice would be....

layers

warm, old clothes

old trainers, walking boots

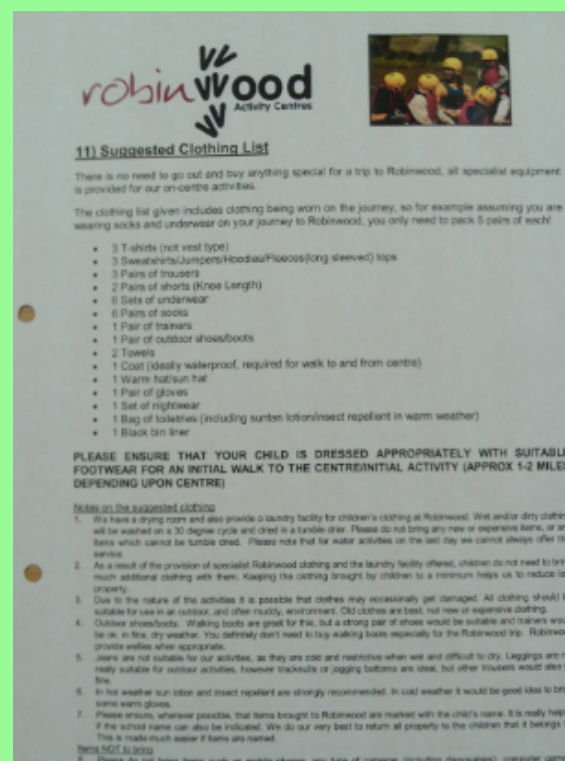





# DOs and Donts in suitcases



A teddy for bed



A notepad

A pen/pencil



A reading book



A water bottle



Think allergies.



Pupils have time in their rooms before 'lights out.'  
There are night lights on all night.



No tablets, phones, cameras. It's screen free time!

# Cost and Payment

**Robinwood - £289 Coach - ?**

**Estimated total cost - £320**

Pay via ParentPay

£30 deposit required by 19th July to secure our school booking.

The full amount can be paid in installments.

Half price for Pupil Premium Children.

Total payment must be completed by:

Friday 10th January 2025

# Whilst there...

There will be a daily post on the school website to update you with news and photos.

It's a Year 4 residential so we try to strike a balance between groups!

There will be no contact with home.

In case of emergencies, I will ring parents.

If you need to contact us, please phone the school office or Robinwood directly if out of school hours.

# Robinwood countdown

19th July 2024 - Final date for deposits.

10th January 2025 - Full amount to be paid.

22nd January 2025 - Medical forms sent home.

29th January 2025 - Pack sent home with souvenir form, clothing kit, final arrangement details.

3rd February 2025 - Final date for medical forms returned to school.

26th February 2025 - Deadline for souvenir forms and souvenir payment.

# Activities - FAQs

## The Lake...

It is man-made with no rocks or logs at the bottom. If children fall in, they can stand up.

## Caving...

The caves are man-made with hatches allowing access for instructors and children as required.

## Piranha Pool...

There are NO piranhas. But we don't tell the children that!

## Heights...

4 activities involve heights (zip wire, giant swing, trapeze, climbing) but children can choose their level.

## The Walk...

It's a bit of an uphill walk from the coach park! Sturdy walking boots/shoes and warm, waterproof clothing are a must!

# Questions

